

# PA CASSETTE

# SYSTEM



PA sliding system doors hidden in the wall (pocket system) - STANDARD 10 vintage oak



STANDARD 10 - PA cassette sand oak

## DECORS

<b>PAINTED</b>	white	cashmere	latte	ashen			
<b>3D</b>	grand oak	elm	Polish oak 3D				
<b>DRE CELL</b>	white (textured)	White matt	white pine	siberian elm	sand oak	bleached oak textured	vintage oak
walnut	premium natur oak	anthracite elm	dark wenge	marrone chestnut textured	evoked oak	caramel walnut	silver
light gray matt	warm gray matt	cashmere matt	sage oak (textured)	sage matt	dark olive matt	dark blue matt	black matt 2
concrete oxide*	antique copper*						

\*decor available while stocks last, \*\*\*decor only in horizontal grain

white - UV Premium acrylic varnish - RAL 9003  
 Cashmere - Premium UV Acrylic Varnish - NCS S2002-Y50R  
 Latte - Premium UV Acrylic Varnish - Flugger 4362, NCS S1505-Y50R  
 ashen - Premium UV acrylic varnish - RAL 7035

# PA DOOR FRAME CASSETTE

SLIDING DOOR LEAVES

interior doors

## PA DOOR FRAME CASSETTE

System assembly involves embedding the cassette in the construction of profiles used to build a plasterboard wall (or other construction) with a thickness of:

- 100 mm for the PA 100 mm door frame cassette
- 125 mm for the PA 125 mm door frame cassette

Next, wide surfaces construction with the usage of 12.5mm plasterboards (plasterboards must be purchased separately) and finishing these surfaces and assembly of Tunnel Cassette Cover.

**NOTE:** VETRO A, VETRO D, VETRO D2, VETRO E and VETRO B door leaves with a width of "70" do not fit the 100 mm and 125 mm PA cassettes.

**In addition, the 100 mm PA cassettes cannot be used with door leaves with locks and panel construction doors with glazing or panels**

## THE SET INCLUDES:

- cassette elements made of aluminum elements and additional assembly accessories
- elements which allows to decorate build in sliding system - so called tunnel cassette cover with architraves 80 mm wide

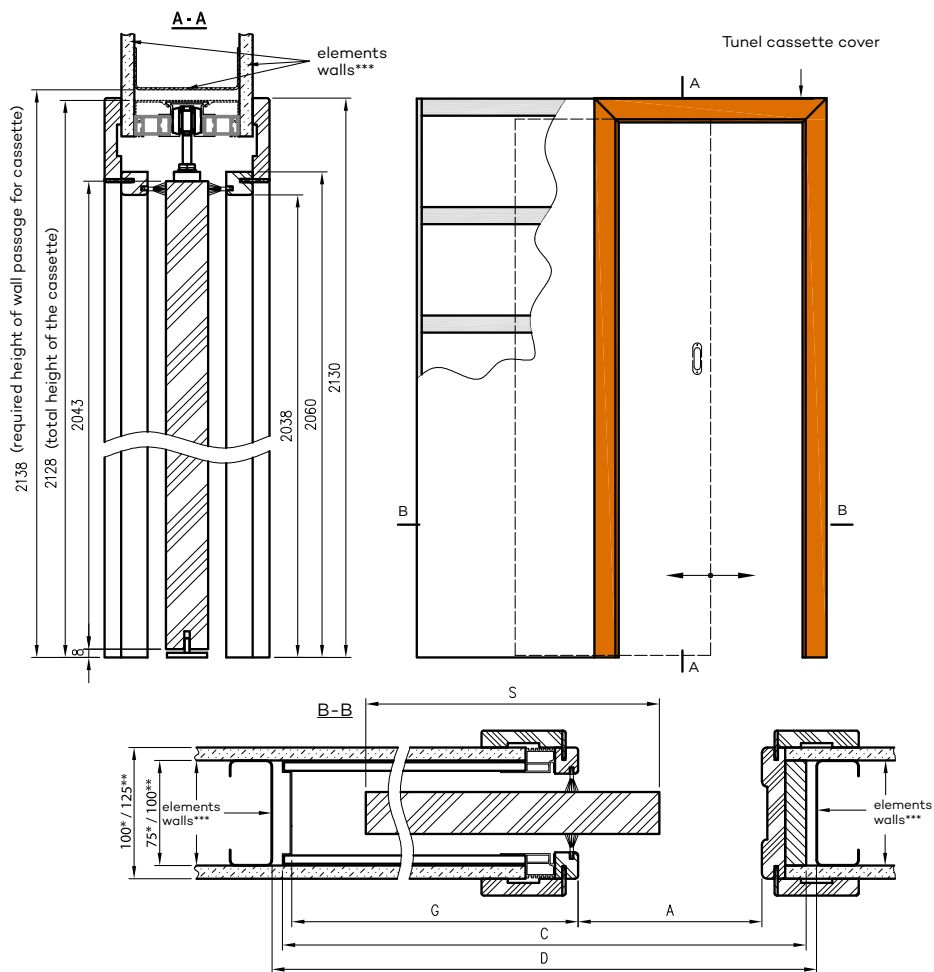

Width	A	S	C	D	G
60	600	644	1310	1330	656
70	700	744	1510	1530	756
80	800	844	1710	1730	856
90	900	944	1910	1930	956
100	1000	1044	2110	2130	1056

\* dimensions refer to the 100mm PA cassette

\*\* dimensions refer to 125mm PA cassette

\*\*\* wall elements are not components of the product

C - total width of cassette

D - width of walls passage prepared for cassette

G - depth of ready cassette