

ADJUSTABLE TUNNEL

WITH ARCHITRAVE T80 or T63

APPLICATION

Adjustable tunnel is a decorative cover of wall passage. It can be used as a separate solution or as an integral part of the sliding wall-mounted system NT.

The adjustable tunnel is a product which is, at first glance visually similar to adjustable door frames, but with a few differences:

- there is no possibility to mount any hinges
- there is no latch strike plate
- no milling for the seal, different height and span of the front and rear architraves (E and F values in the tables)

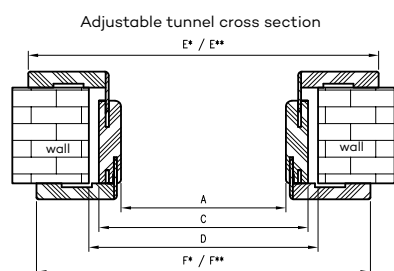

D - required width of wall opening
*refers to Adjustable Tunnel with T63
*refers to Adjustable Tunnel with T80 architrave

TUN cross-section with T80

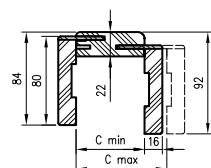

TUN cross-section with T63

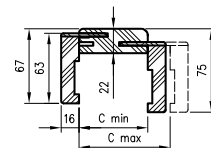

Vertical cross-section of adjustable tunnel with T80 architrave

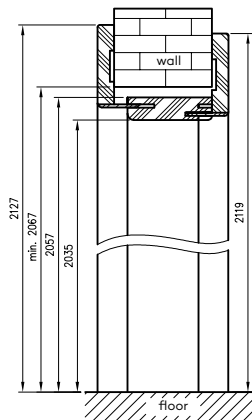

Vertical section of the adjustable tunnel with T63 architrave

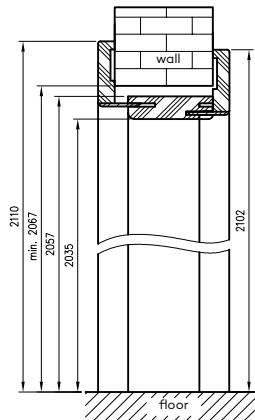

Required height of the wall opening 2067 mm.

NOTE: To ensure the highest quality of painted tunnels, before painting process they are coated with special material which constitutes solid base.

SINGLE ADJUSTABLE TUNNEL

symbol	60	70	80	90	100
A	602	702	802	902	1002
C	646	746	846	946	1046
D	664	764	864	964	1064
E*	752	852	952	1052	1152
E**	786	886	986	1086	1186
F*	736	836	936	1036	1136
F**	770	870	970	1070	1170

DOUBLE ADJUSTABLE TUNNEL

symbol	120	130	140	150	160	170	180	190	200	symbol	120	130	140	150	160	170	180	190	200
A	1200	1300	1400	1500	1600	1700	1800	1900	2000	E**	1384	1484	1584	1684	1784	1884	1984	2084	2184
C	1244	1344	1444	1544	1644	1744	1844	1944	2044	F*	1334	1434	1534	1634	1734	1834	1934	2034	2134
D	1264	1364	1464	1564	1664	1764	1864	1964	2064	F**	1368	1468	1568	1668	1768	1868	1968	2068	2168
E*	1350	1450	1550	1650	1750	1850	1950	2050	2150										

OPTIONS AVAILABLE WITH EXTRA CHARGE

Tunnel for double leaf door: +30%

2nd group CPL - CPL laminate natural halifax oak.
Black ST decor, CPL cashmere laminate, light casella oak,
available only with T80 architrave.

wall thickness	
Cmin	Cmax
62	87
87	112
107	132
127	152
147	172
167	192
187	212
207	232
227	252
247	272
267	292
287	312